

# SERIES

# BRW

# OVERLY

DOOR COMPANY

574 WEST OTTERMAN STREET  
 POST OFFICE BOX 70  
 GREENSBURG, PA 15601-0070  
 TELEPHONE: 724-834-7300  
 FAX: 724-830-2871

## UL752 LEVEL 4, FLUSH, NON-UL FIRE RATED SINGLE SWING METAL FRAME AND WOOD DOOR ASSEMBLY

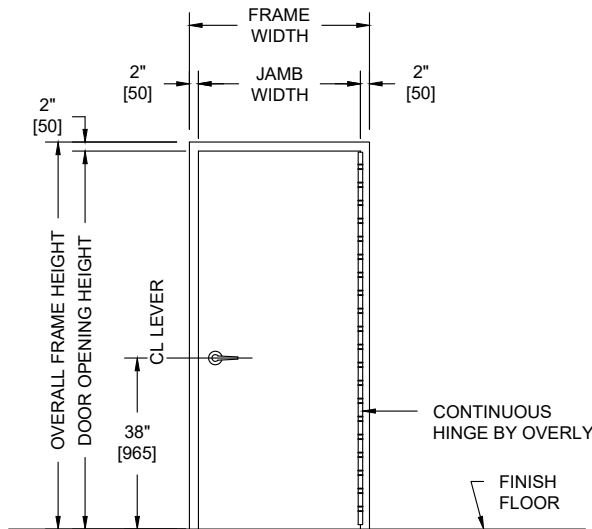

**PUBLIC SIDE ELEVATION**  
 RIGHT HAND REVERSE BEVEL SHOWN

**SECURED AREA (INTERIOR)**

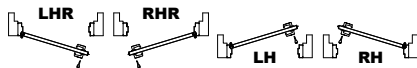

**(KEY) SIDE**

**PUBLIC AREA (EXTERIOR)**

**NOTES:**

1. Frame UL listed for UL752, Level 4 bullet resistance. Door fabricated using UL752 listed, Level 4 fiberglass BR liner.
2. Doors are for interior use only.
3. Doors hung in carbon steel frame. All exposed surfaces of frame to receive one coat of rust inhibitive prime paint.
4. Units cannot be UL fire rated.
5. Maximum door leaf size is 4'-0" x 10'-0".
6. Door weight is 20.3 pounds / sq. foot.
7. Doors to be hung on continuous hinges by Overly. Locks required to be BHMA Grade 1, 2, or 3. Electrical hardware with raceways available. Consult factory for specifics.
8. MDO and veneer faces available in unfinished, primed, clear, or custom stains. Plastic laminates also available.

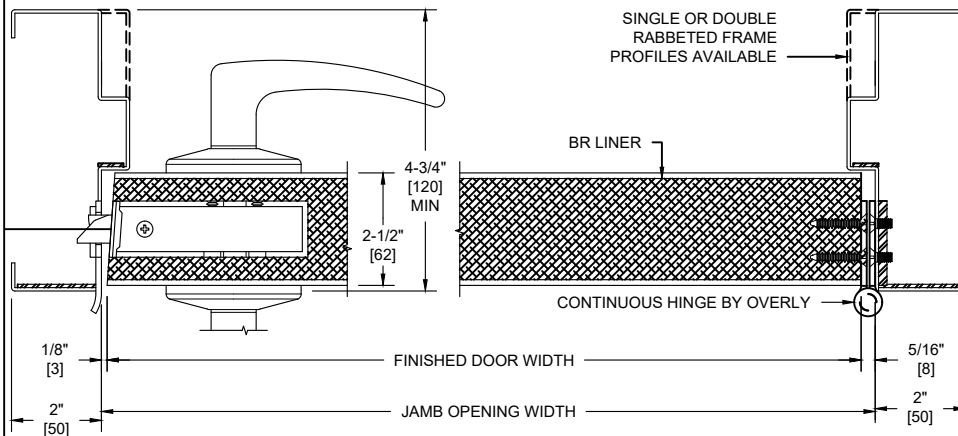

**HORIZONTAL SECTION**

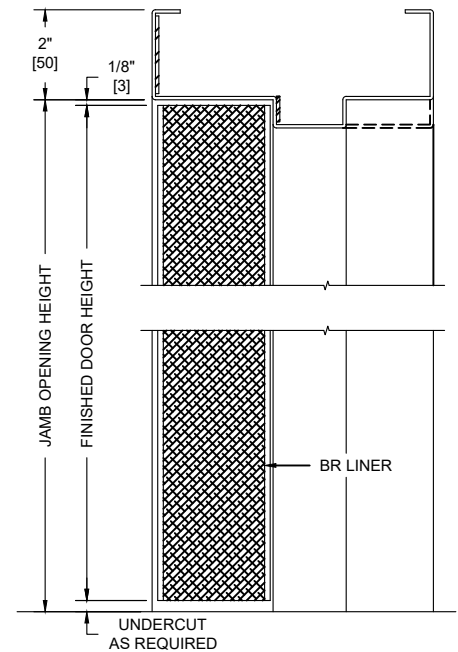

**VERTICAL SECTION**

| UL LEVEL | AMMUNITION                             | MINIMUM VELOCITY<br>FPS/MP5 | NUMBER OF<br>SHOTS |
|----------|--|-----------------------------|--------------------|
| 4        | .30 CALIBER RIFLE LEAD CORE SOFT POINT | 2540 / 774                  | 1                  |