

MODEL NO. 4925139 / UL FIRE RATED / STC 49 / DUAL GLAZED SOUND CONTROL DOOR AND FRAME ASSEMBLY / SINGLE COMPRESSION SEALS

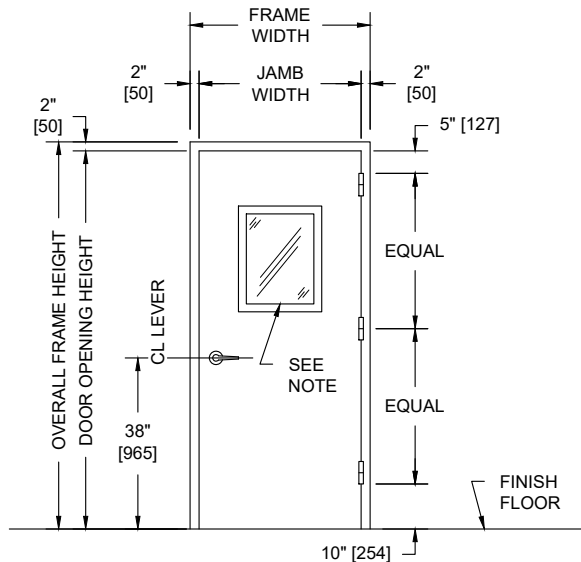

PUBLIC SIDE ELEVATION
RIGHT HAND REVERSE BEVEL SHOWN

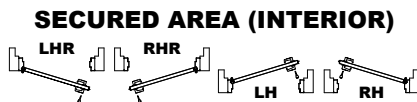

**(KEY) SIDE
PUBLIC AREA (EXTERIOR)**

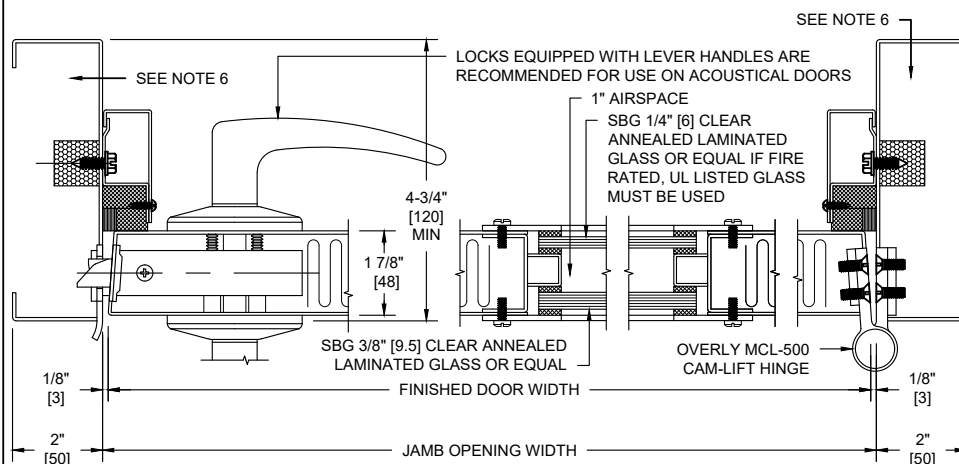

HORIZONTAL SECTION

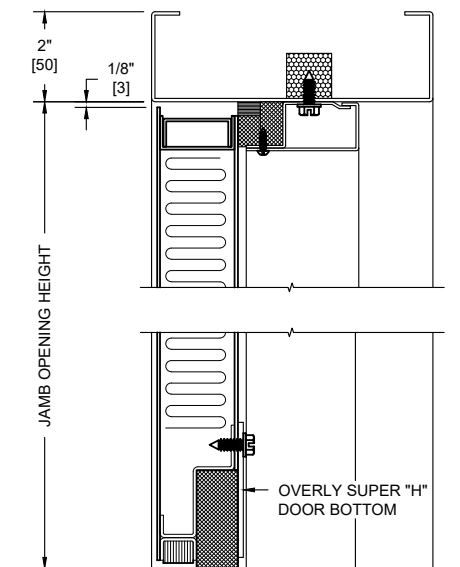

VERTICAL SECTION

| SOUND TRANSMISSION LOSS IN dB AT FREQUENCY / HERTZ | | | | | | | | | | | | | | | | | |
|----------------------------------------------------|-----|-----|-----|-----|-----|-----|-----|-----|-----|------|------|------|------|------|------|------|------|
| 100 | 125 | 160 | 200 | 250 | 315 | 400 | 500 | 630 | 800 | 1000 | 1250 | 1600 | 2000 | 2500 | 3150 | 4000 | 5000 |
| 30 | 28 | 32 | 34 | 38 | 43 | 45 | 48 | 51 | 53 | 52 | 50 | 52 | 55 | 57 | 58 | 56 | 55 |

ALL DIMENSIONS
BOTH IN INCHES
AND MILLIMETERS