

SERIES

BLS

OVERLY
DOOR COMPANY

574 WEST OTTERMAN STREET
POST OFFICE BOX 70
GREENSBURG, PA 15601-0070
TELEPHONE: 724-834-7300
FAX: 724-830-2871

MODEL NO. MRB2-S / SINGLE POINT / UP TO 7.4 PSI / BLAST RESISTANT DOOR AND FRAME ASSEMBLY / SINGLE SWING

NOTES:

1. A 3'-0" x 7'-0" opening can be designed to withstand up to 7.4 psi total static load. Certain hardware restrictions may apply. Final pressure rating will be determined by our Blast Engineering Department once entire product has been specified. See chart below.
2. All exposed surfaces of frame to receive one coat of rust inhibitive prime paint.
3. Door must be equipped with an Overly L7000 Series mortise type lock set and Overly M-1800 extreme duty hinges.
4. Various weather-stripping options are available.
5. Removable and fixed type transom configurations are available.
6. Various size vision lites and side lites available.
7. Also available with E7000 panic device.

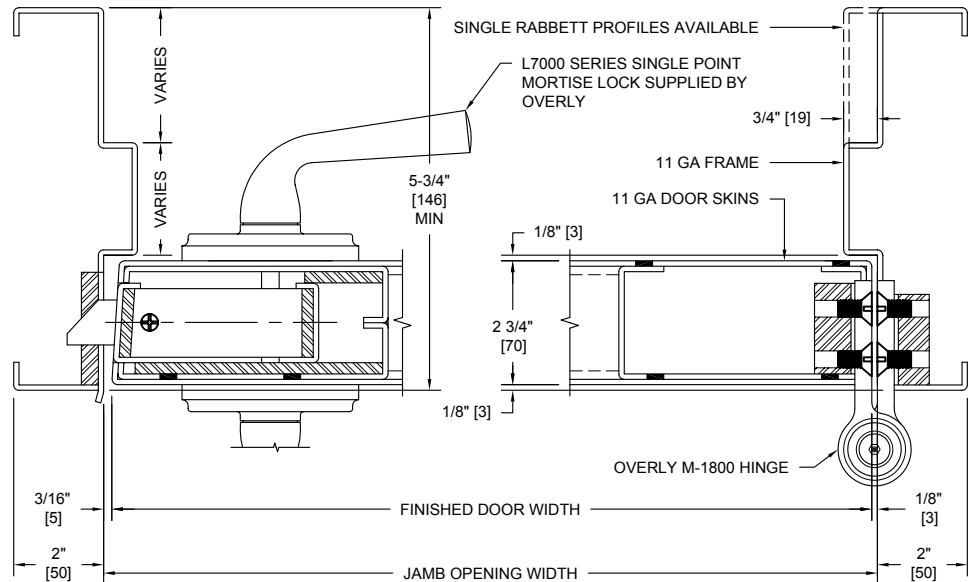

HORIZONTAL SECTION

SECURED AREA (INTERIOR)



(KEY) SIDE

PUBLIC AREA (EXTERIOR)

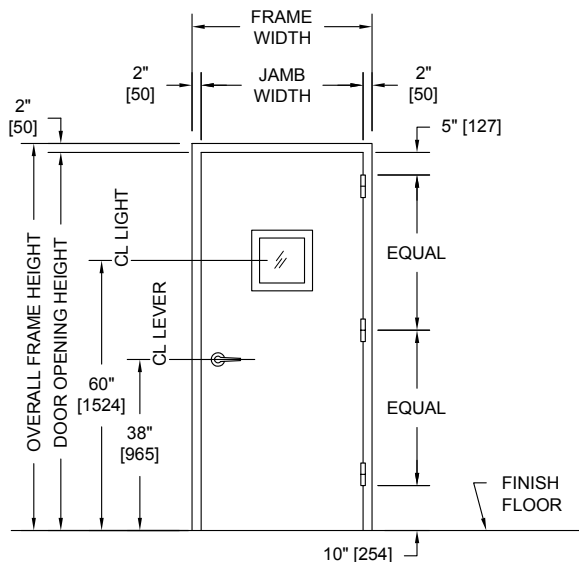

PUBLIC SIDE ELEVATION

RIGHT HAND REVERSE BEVEL SHOWN
SHOWN WITH 10" X 10" VISION LIGHT

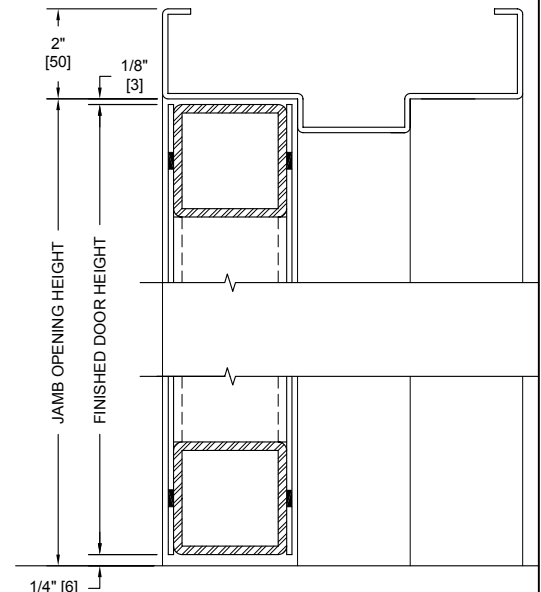

VERTICAL SECTION

PRE-ENGINEERED BLAST DOOR SELECTOR CHART

3'-0" x 7'-0"	3'-0" x 8'-0"	3'-0" x 9'-2"	4'-0" x 7'-0"	4'-0" x 8'-0"
7.04 psi [48.6 kPa]	6.16 psi [42.5 kPa]	6.38 psi [44 kPa]	5.28 psi [36.4 kPa]	4.52 psi [31.2 kPa]

ALL DIMENSIONS
BOTH IN INCHES
AND MILLIMETERS